



Pushing Performance



People | Power | Partnership

HARTING Han-Eco[®] B/Han[®] B Rear-Fit

Han-Eco[®] B/Han[®] B Rear-Fit

So far, the use of connectors means significant and unavoidable efforts when applying cable harnesses to switch cabinets. Assembly is mainly carried out in the field, outside the control cabinet. For this purpose, the cables have to be conducted from the inside to the outside; then, the insulation body is pre-assembled and pushed back into the bulkhead mounted housing on the cabinet wall.

The new Han[®] B and Han-Eco[®] B connectors simplify the installation of switch cabinets. They help to master the challenges by enabling time savings e.g. when it comes to the installation of devices using the industrial standard Han[®] B. Both ends of the prefabricated harnesses can be snapped directly into the housing.

The option speeds up the assembly of control cabinets as well as service and maintenance. Installers no longer have to conduct cables through the wall cut-out and the bulkhead mounted housing before they can equip the inserts. Instead, pre-assembled insulation bodies snap into the bulkhead mounted housings from the rear.



- Door systems and ramps
- Power control cabinet
- Air condition
- Power generation



- Control cabinets
- Pitch systems
- Termination boxes



- Battery storage systems
- Power plant control systems and cabinets
- Power generator sets



- Control cabinets
- Vibratory conveyors
- Connections inside cabinet



Outdoor version available for extreme environmental conditions



Rear mounting of inserts speeds up installation

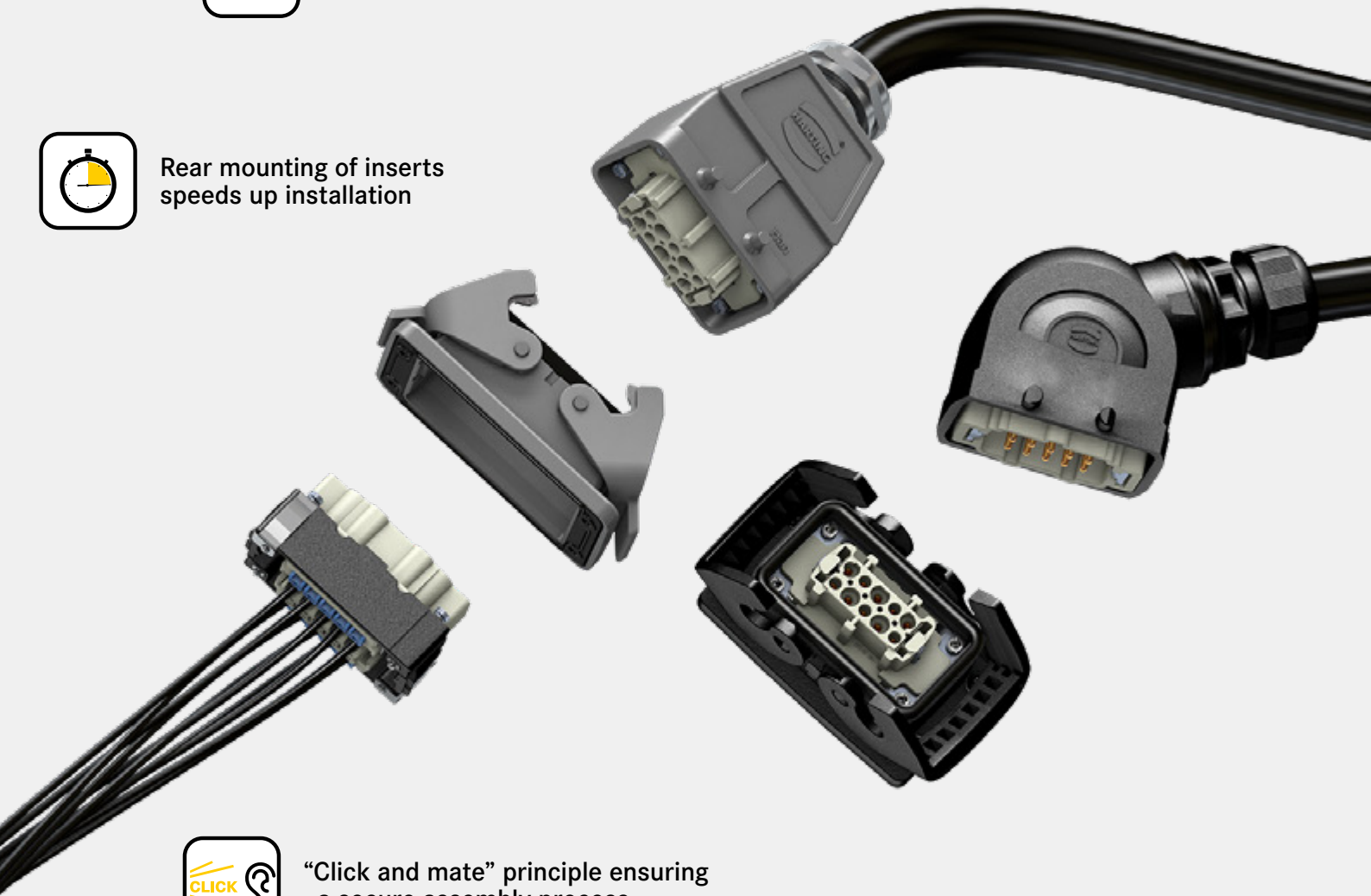

“Click and mate” principle ensuring a secure assembly process



Excellent mechanical robustness combined with minimal weight



IP protected
By usage of hood and housing elements IP66 protection degree can be realised in one connector system



Pushing Performance

HARTING.com –
the gateway to your
local website.

HARTING Technology Group

info@HARTING.com
www.HARTING.com

at@HARTING.com
www.HARTING.at

ch@HARTING.com
www.HARTING.ch